



*Experience superior handling and control
with our precision bike parts*



+91 81919 91985
info@cewautoparts.com
www.cewautoparts.com

BRAKE SHOE



Brake shoes are an important component of drum brake systems, which are commonly found on the front and rear wheels of many vehicles, including motorcycles, cars, and trucks. They are responsible for creating the necessary friction to slow down or stop the vehicle when the brakes are applied.

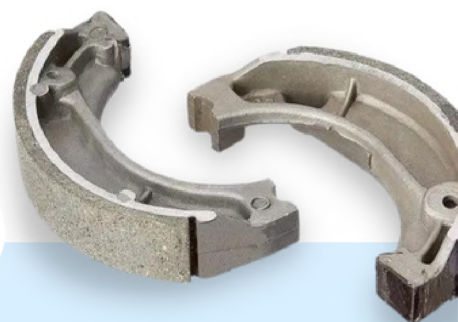

Product Listing



HERO Motorbikes

Set (Pcs.) 1 SET (2 PCS)
HS Code 8714

- | | | |
|---|------------|-----------------------|
| 1 | Model Name | CD 100 (FRONT & REAR) |
| | Part No. | CEW/BS/01 |
| 2 | Model Name | DELUXE (REAR) |
| | Part No. | CEW/BS/02 |
| 3 | Model Name | SPLENDOR (REAR) |
| | Part No. | CEW/BS/03 |
| 4 | Model Name | SPLENDOR + (REAR) |
| | Part No. | CEW/BS/04 |
| 5 | Model Name | PASSION PRO (REAR) |
| | Part No. | CEW/BS/05 |
| 6 | Model Name | CD DAWN (REAR) |
| | Part No. | CEW/BS/06 |
| 7 | Model Name | SPLENDOR (FRONT) |
| | Part No. | CEW/BS/07 |

8 *Model Name* **GLAMOUR REAR**
Part No. **CEW/BS/08**

9 *Model Name* **SUPER SPLENDOR
(FRONT & REAR)**
Part No. **CEW/BS/09**



BAJAJ Motorbikes

Set (Pcs.) **1 SET (2 PCS)**
HS Code **8714**

10 *Model Name* **PLATINA (FRONT & REAR)**
Part No. **CEW/BS/10**

11 *Model Name* **CALIBER FRONT& REAR**
Part No. **CEW/BS/11**

12 *Model Name* **BOXER 150
(FRONT & REAR)**
Part No. **CEW/BS/12**

13 *Model Name* **DISCOVER
(FRONT & REAR)**
Part No. **CEW/BS/13**

14 *Model Name* **PULSAR REAR**
Part No. **CEW/BS/14**

15 *Model Name* **AVENGER 150/200 REAR**
Part No. **CEW/BS/15**



TVS Motorbikes

Set (Pcs.) **1 SET (2 PCS)**
HS Code **8714**

16 *Model Name* **SUZ TVS AX
(FRONT & REAR)**
Part No. **CEW/BS/16**

17 *Model Name* **STAR CITY
(FRONT & REAR)**
Part No. **CEW/BS/17**

18 *Model Name* **STAR SPORT
(FRONT & REAR)**
Part No. **CEW/BS/18**

19 *Model Name* **VICTOR (FRONT & REAR)**
Part No. CEW/BS/19

20 *Model Name* **JUPITER (FRONT & REAR)**
Part No. CEW/BS/20

21 *Model Name* **WEGO (FRONT & REAR)**
Part No. CEW/BS/21

22 *Model Name* **APACHE RTR (REAR)**
Part No. CEW/BS/22



HONDA Motorbikes

Set (Pcs.) **1 SET (2 PCS)**
HS Code **8714**

23 *Model Name* **ACTIVA N/M (FRONT & REAR)**
Part No. CEW/BS/23

24 *Model Name* **SHINE (REAR)**
Part No. CEW/BS/24

25 *Model Name* **UNICORN (REAR)**
Part No. CEW/BS/25



SUZUKI Motorbikes

Set (Pcs.) **1 SET (2 PCS)**
HS Code **8714**

26 *Model Name* **ACCESS 125 (FRONT & REAR)**
Part No. CEW/BS/26

ROYAL ENFIELD

ROYAL ENFIELD Motorbikes



Set (Pcs.) 1 SET (2 PCS)

HS Code 8714

27 Model Name **BULLET N/M
(REAR)**

Part No. CEW/BS/27

 **YAMAHA**

YAMAHA Motorbikes



Set (Pcs.) 1 SET (2 PCS)

HS Code 8714

28 Model Name **YAHAMA FAZER
(FRONT & REAR)**

Part No. CEW/BS/28

DISC BRAKE PAD



Bike disc pads, also known as brake pads, are an essential component of a motorcycle's braking system. They are responsible for creating the friction necessary to slow down or stop the bike when the rider applies the brakes.



Product Listing



HERO Motorbikes

Set (Pcs.) 1 SET (2 PCS)
HS Code 8714

4 Model Name **KARIZMA O/M (REAR)**
Part No. CEW/DP/04

6 Model Name **ZMR (REAR)**
Part No. CEW/DP/06

1 Model Name **CBZ O/M (FRONT)**
Part No. CEW/DP/01

2 Model Name **AMBITION (FRONT)**
Part No. CEW/DP/02

3 Model Name **KARIZMA O/M (FRONT)**
Part No. CEW/DP/03

5 Model Name **ZMR (FRONT)**
Part No. CEW/DP/05

7 Model Name **CBZ STAR (FRONT)**
Part No. CEW/DP/07

8 *Model Name* **PASSION PRO (FRONT)**
Part No. CEW/DP/08

9 *Model Name* **PASSION X PRO (FRONT)**
Part No. CEW/DP/09

10 *Model Name* **PASSION I-3S (FRONT)**
Part No. CEW/DP/10

11 *Model Name* **SUPER SPLENDOR (FRONT)**
Part No. CEW/DP/11

12 *Model Name* **HUNK (FRONT)**
Part No. CEW/DP/12

13 *Model Name* **XTREME (FRONT)**
Part No. CEW/DP/13

14 *Model Name* **GLAMOUR (FRONT)**
Part No. CEW/DP/12

15 *Model Name* **ACHIEVER (FRONT)**
Part No. CEW/DP/15

16 *Model Name* **I SMART 110 (FRONT)**
Part No. CEW/DP/16

17 *Model Name* **CBZ XTREME (FRONT)**
Part No. CEW/DP/17

TVS 



TVS Motorbikes

Set (Pcs.) **1 SET (2 PCS)**

HS Code **8714**

18 *Model Name* **APACHE (FRONT)**
Part No. CEW/DP/18

19 *Model Name* **APACHE 200 (FRONT)**
Part No. CEW/DP/19

20 *Model Name* **APACHE RTR (FRONT)**
Part No. CEW/DP/20

21 *Model Name* **VICTOR NEW MODEL (FRONT)**
Part No. CEW/DP/21

22 *Model Name* **APACHE RTR (REAR)**
Part No. CEW/DP/22

23 *Model Name* **APACHE - 200 (REAR)**
Part No. CEW/DP/23

24 *Model Name* **DAZZLER (REAR)**
Part No. CEW/DP/24

25 *Model Name* JUPITER CLASSIC (FRONT)
Part No. CEW/DP/25

26 *Model Name* TVS NTORQ 125CC (FRONT)
Part No. CEW/DP/26

27 *Model Name* DAZZLER (FRONT)
Part No. CEW/DP/27

28 *Model Name* X - BLADE (FRONT)
Part No. CEW/DP/28

ROYAL ENFIELD

ROYAL ENFIELD Motorbikes



Set (Pcs.) 1 SET (2 PCS)
HS Code 8714

29 *Model Name* THUNDERBIRD(FRONT)
Part No. CEW/DP/29

30 *Model Name* APACHE 200 (FRONT)
Part No. CEW/DP/30

31 *Model Name* APACHE RTR (FRONT)
Part No. CEW/DP/31

32 *Model Name* VICTOR NEW MODEL (FRONT)
Part No. CEW/DP/32

33 *Model Name* APACHE RTR (REAR)
Part No. CEW/DP/33

34 *Model Name* APACHE - 200 (REAR)
Part No. CEW/DP/34

35 *Model Name* DAZZLER (REAR)
Part No. CEW/DP/35

36 *Model Name* APACHE - 200 (REAR)
Part No. CEW/DP/36

37 *Model Name* DAZZLER (REAR)
Part No. CEW/DP/37



KTM Motorbikes

Set (Pcs.) 1 SET (2 PCS)
HS Code 8714

38 Model Name KTM 200 DUKE (REAR)
Part No. CEW/DP/38

39 Model Name KTM 390 DUKE (REAR)
Part No. CEW/DP/39



BAJAJ Motorbikes

Set (Pcs.) 1 SET (2 PCS)
HS Code 8714

40 Model Name PULSAR 150 (FRONT)
Part No. CEW/DP/40

41 Model Name PULSAR 180 (FRONT)
Part No. CEW/DP/41

42 Model Name PULSAR 200 (FRONT)
Part No. CEW/DP/42

43 Model Name PULSAR 220 (FRONT)
Part No. CEW/DP/43

44 Model Name DISCOVER (FRONT)
Part No. CEW/DP/44

45 Model Name AVENGER (FRONT)
Part No. CEW/DP/45

46 Model Name DOMINAR (FRONT)
Part No. CEW/DP/44

47 Model Name DOMINAR NS 200 (FRONT)
Part No. CEW/DP/45

48 *Model Name* **DOMINAR RS 200 (FRONT)**
Part No. CEW/DP/48

49 *Model Name* **WEGO (FRONT)**
Part No. CEW/DP/49

50 *Model Name* **PULSAR UG-3 (REAR)**
Part No. CEW/DP/50

51 *Model Name* **PULSAR UG-4 (220 CC N/M) (REAR)**
Part No. CEW/DP/51

52 *Model Name* **PULSAR NS 200 (REAR)**
Part No. CEW/DP/52

53 *Model Name* **PULSAR RS 200 (REAR)**
Part No. CEW/DP/53

54 *Model Name* **DOMINAR (REAR)**
Part No. CEW/DP/54

55 *Model Name* **PULSAR UG-5 (BS4 & BS6)**
Part No. CEW/DP/55

56 *Model Name* **PULSAR 220 (REAR) 2019**
Part No. CEW/DP/56

57 *Model Name* **PULSAR 150 TWIN DISC (REAR)**
Part No. CEW/DP/57



HONDA Motorbikes

Set (Pcs.) **1 SET (2 PCS)**
HS Code **8714**

58 *Model Name* **UNICORN (FRONT)**
Part No. CEW/DP/58

59 *Model Name* **DAZZLER(FRONT)**
Part No. CEW/DP/59

60 *Model Name* **TWISTER (FRONT)**
Part No. CEW/DP/60

61 *Model Name* **STUNNER (FRONT)**
Part No. CEW/DP/61

62 *Model Name* **SHINE (FRONT)**
Part No. CEW/DP/62

63 *Model Name* **UNICORN (REAR)**
Part No. CEW/DP/63

64 *Model Name* **CBR 150 (REAR)**
Part No. CEW/DP/64

65 *Model Name* **HORNET (REAR)**
Part No. CEW/DP/65

66 *Model Name* **TRIGGER (REAR)**
Part No. CEW/DP/66

67 *Model Name* **HONDA UNICORN
160**
Part No. CEW/DP/67

68 *Model Name* **HONDA DIO**
Part No. CEW/DP/68

69 *Model Name* **SHINE N/M (FRONT)**
Part No. CEW/DP/69

70 *Model Name* **LIVO (FRONT)**
Part No. CEW/DP/70

71 *Model Name* **CB SHINE (FRONT)**
Part No. CEW/DP/71

72 *Model Name* **CBR 150 (FRONT)**
Part No. CEW/DP/72

73 *Model Name* **SP SHINE (FRONT)**
Part No. CEW/DP/73

74 *Model Name* **HONDA TRIGGER
(FRONT)**
Part No. CEW/DP/74

75 *Model Name* **UNICORN160**
Part No. CEW/DP/75

76 *Model Name* **ACTIVA N/M 125CC
(FRONT)**
Part No. CEW/DP/76

77 *Model Name* **AVIATOR (FRONT)**
Part No. CEW/DP/77

78 *Model Name* **HONDA GRAZIA
(FRONT)**
Part No. CEW/DP/78



YAMAHA Motorbikes

Set (Pcs.) **1 SET (2 PCS)**

HS Code **8714**

79 *Model Name* **YAMAHA SZ RR (FRONT)**
Part No. CEW/DP/79

80 *Model Name* **YAMAHA RAY- ZR
(FRONT)**
Part No. **CEW/DP/80**

81 *Model Name* **YAMAHA SALUTO
(FRONT)**
Part No. **CEW/DP/81**



SUZUKI Motorbikes

Set (Pcs.) **1 SET (2 PCS)**
HS Code **8714**

82 *Model Name* **HEAT (FRONT)**
Part No. **CEW/DP/82**

83 *Model Name* **ZEUS (FRONT)**
Part No. **CEW/DP/83**

84 *Model Name* **GS-150R (FRONT)**
Part No. **CEW/DP/83**

85 *Model Name* **GS-150R (FRONT)**
Part No. **CEW/DP/84**

86 *Model Name* **ACCESS 125CC
(FRONT)**
Part No. **CEW/DP/85**

87 *Model Name* **GIXXER (REAR)**
Part No. **CEW/DP/84**

88 *Model Name* **INTRUDER (REAR)**
Part No. **CEW/DP/85**

CLUTCH PLATE



Clutch plate is an essential component of a vehicle's clutch system, responsible for transferring power from the engine to the transmission. It is made of high-quality materials that are designed to withstand the heat, friction, and wear and tear associated with daily driving.

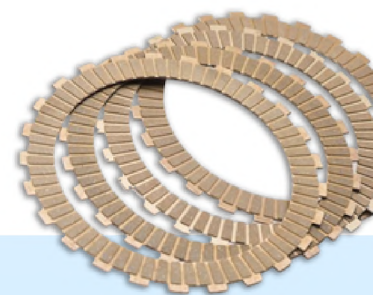

Product Listing



BAJAJ Motorbikes

Set (Pcs.) 1 SET (2 PCS)
HS Code 8714

3 Model Name **PLATINA COMFORTEC**
Part No. CEW/CP/03

5 Model Name **DISCOVER 125 CC (ST & M)**
Part No. CEW/CP/05

1 Model Name **PLATINA**
Part No. CEW/CP/01

2 Model Name **CT-100**
Part No. CEW/CP/02

4 Model Name **DISCOVER 100 CC**
Part No. CEW/CP/04

6 Model Name **PLUSAR 150 UG3**
Part No. CEW/CP/06

7 *Model Name* **PULSAR 150 UG4**
Part No. CEW/CP/07

8 *Model Name* **AVENGER STREET - 150**
Part No. CEW/CP/08

9 *Model Name* **DISCOVER 150**
Part No. CEW/CP/09

10 *Model Name* **PULSAR 135**
Part No. CEW/CP/10

11 *Model Name* **PULSAR 180 UG3**
Part No. CEW/CP/11

12 *Model Name* **PULSAR 200 UG3**
Part No. CEW/CP/12

13 *Model Name* **PULSAR 220 UG3**
Part No. CEW/CP/13

14 *Model Name* **PULSAR 180 UG4**
Part No. CEW/CP/14

15 *Model Name* **PULSAR 200 UG4**
Part No. CEW/CP/15

16 *Model Name* **PULSAR 220 UG4**
Part No. CEW/CP/16

17 *Model Name* **AVENGER STREET - 220**
Part No. CEW/CP/17

18 *Model Name* **AVENGER DESERT - 220**
Part No. CEW/CP/18



HONDA Motorbikes

Set (Pcs.) **1 SET (2 PCS)**

HS Code **8714**

19 *Model Name* **HONDA SHINE**
Part No. CEW/CP/19



HERO Motorbikes

Set (Pcs.) 1 SET (2 PCS)

HS Code 8714

20 Model Name **CD-100**
Part No. CEW/CP/20

21 Model Name **PASSION**
Part No. CEW/CP/21

22 Model Name **DAWN**
Part No. CEW/CP/22

23 Model Name **SPLENDOR**
Part No. CEW/CP/23

24 Model Name **SPLENDOR +**
Part No. CEW/CP/24

25 Model Name **PASSION +**
Part No. CEW/CP/25

26 Model Name **PASSION I - 35**
Part No. CEW/CP/26

27 Model Name **SMART 110**
Part No. CEW/CP/27

28 Model Name **SUPER SPLENDOR**
Part No. CEW/CP/28

29 Model Name **GLAMOUR**
Part No. CEW/CP/29



TVS Motorbikes

Set (Pcs.) 1 SET (2 PCS)

HS Code 8714

30 Model Name **STAR CITY**
Part No. CEW/CP/30

31 Model Name **VICTOR**
Part No. CEW/CP/31

32 *Model Name* **STAR SPORT**
Part No. CEW/CP/32

33 *Model Name* **STAR DLX**
Part No. CEW/CP/33

34 *Model Name* **APACHE RTR 160**
Part No. CEW/CP/34

35 *Model Name* **APACHE RTR 180**
Part No. CEW/CP/35

CABLES



Control and speedo cables are essential components of a motorcycle's control system. They are responsible for transmitting mechanical force and motion from the rider's controls to various parts of the motorcycle, such as the throttle, clutch, brakes, and speedometer.



Product Listing

CLUTCH CABLES

Set (Pcs.) **1 PCS**
HS Code **8714**

1 Model Name **SPL/PRO/CD/DX/SUPER**
Part No. **CEW/CBL/01**

2 Model Name **CT100/PLATINA**
Part No. **CEW/CBL/02**

3 Model Name **SPL/PRO/CD/DX/SUPER**
Part No. **CEW/CBL/03**

4 Model Name **CT100/PLATINA**
Part No. **CEW/CBL/04**

5 Model Name **SPL/PRO/CD/DX/SUPER**
Part No. **CEW/CBL/05**

6 Model Name **CT100/PLATINA**
Part No. **CEW/CBL/06**

7 Model Name **SPL/PRO/CD/DX/SUPER**
Part No. **CEW/CBL/07**

8 Model Name **CT100/PLATINA**
Part No. **CEW/CBL/08**

ACC CABLES

Set (Pcs.) 1 PCS
HS Code 8714

9	<i>Model Name</i>	SPL/SUP	10	<i>Model Name</i>	STARCITY
	<i>Part No.</i>	CEW/CBL/09		<i>Part No.</i>	CEW/CBL/10
11	<i>Model Name</i>	DIS.100	12	<i>Model Name</i>	DIS.125/135
	<i>Part No.</i>	CEW/CBL/11		<i>Part No.</i>	CEW/CBL/12
13	<i>Model Name</i>	PULSAR 200/220	14	<i>Model Name</i>	HONDA SHINE
	<i>Part No.</i>	CEW/CBL/13		<i>Part No.</i>	CEW/CBL/14
15	<i>Model Name</i>	DREAM YUGA	16	<i>Model Name</i>	XPRO/GLAMER N/M
	<i>Part No.</i>	CEW/CBL/15		<i>Part No.</i>	CEW/CBL/16
17	<i>Model Name</i>	CT 100/PLATINA O/M	18	<i>Model Name</i>	CT 100/PLATINA N/M
	<i>Part No.</i>	CEW/CBL/17		<i>Part No.</i>	CEW/CBL/18
19	<i>Model Name</i>	PLATINA ES	20	<i>Model Name</i>	BULLET
	<i>Part No.</i>	CEW/CBL/19		<i>Part No.</i>	CEW/CBL/20

SPEEDO CABLES

Set (Pcs.) 1 PCS
HS Code 8714

21	<i>Model Name</i>	SUPER SPLENDER	22	<i>Model Name</i>	PRO DIGITAL
	<i>Part No.</i>	CEW/CBL/21		<i>Part No.</i>	CEW/CBL/22
23	<i>Model Name</i>	SHINE/CD DX	24	<i>Model Name</i>	DIS 100
	<i>Part No.</i>	CEW/CBL/23		<i>Part No.</i>	CEW/CBL/24

25 *Model Name* **STARCITY**
Part No. **CEW/CBL/25**

26 *Model Name* **SPORTS**
Part No. **CEW/CBL/26**

27 *Model Name* **ACTIVA N/M**
Part No. **CEW/CBL/27**

BS6 ACC CABLES

Set (Pcs.) **1 PCS**
HS Code **8714**

28 *Model Name* **ACTIVA N/M**
Part No. **CEW/CBL/29**

29 *Model Name* **JUPITER N/M**
Part No. **CEW/CBL/30**



MANUFACTURING UNIT:

Creative Engineering Works

Khasra No. 1825, Salempur Mehdood, 2, IP 2, Haridwar, Uttarakhand 249403

www.cewautoparts.com

**For any query,
call/whatsApp us on 8191991985 or mail us on info@cewautoparts.com**